

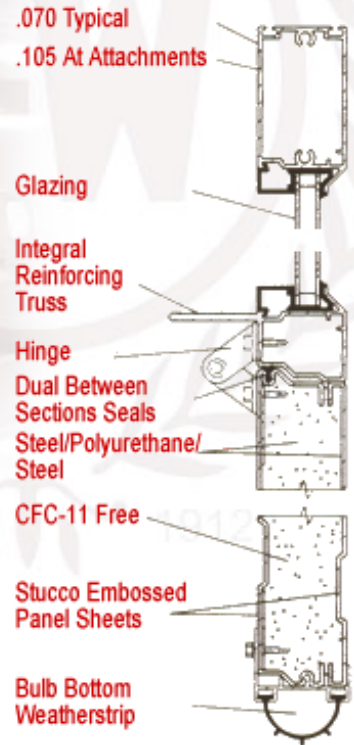

# Richards-Wilcox Canada

## Alumatite aluminium doors



**A175T**

Richards-Wilcox Alumatite sectional doors are an attractive solution where unobstructed visibility is required. Designed to withstand the rigours of busy service centres these doors are available for openings up to 16 feet wide and 16 feet high.

Integral horizontal reinforcing trusses and dual finned between section seals are only two of the standard features that set them apart from other doors available on the market today.

All the Alumatite doors are manufactured from 6063-T6 high quality aluminum alloy extrusions and a standard finish of clear anodized or Duracron thermal setting white enamel, custom finishes are also available.

The Richards-Wilcox reputation for quality sectional door products is clearly reflected in the distinctive appearance and performance of our Alumatite products.

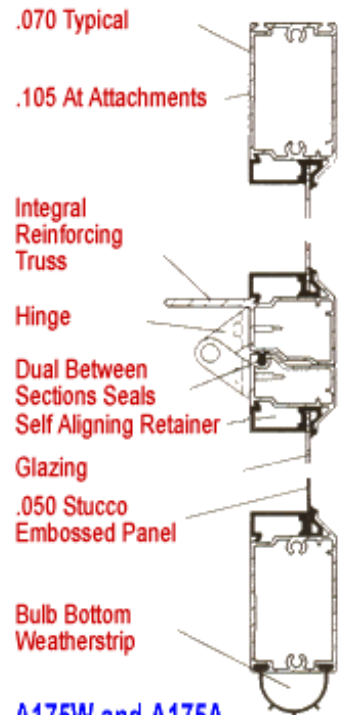

**A175W and A175A**



**product specifications**

**ALUMATITE SECTIONAL ALUMINUM DOORS MODELS A175A, A175W, A175T**

**Sections:**

Section framing: 45mm (1 3/4") thick sections fabricated from 6063-T6 aluminum alloy extrusions, extrusion thickness 1.83mm (0.075") thick, and 3.7mm (0.15") thick at hardware mounting locations. Panelled sections fabricated from 1.29mm (0.05") thick stucco embossed aluminum sheet. End stiles: 86mm (3 3/8") wide aluminum for single end roller brackets; 162mm (6 3/8") for double end roller brackets. Centre stiles: 50mm (2") wide, aluminum. Pair of meeting rails: 83mm (3 1/4") high, aluminum. A175, A175A and A175T: Top rail of bottom section 86mm (3 3/8") high, aluminum. A115A and A175W: Bottom rail of bottom section 86mm (3 3/8") high, aluminum. A175T: Bottom section (optional top section) of 45mm (1 3/4") steel/polyurethane/steel sandwich panel, CFC-11 free, stucco embossed, ribbed reinforced, colour white, thermal values of RSI=2.84 (R=16.4); USI=0.34 (U=0.061).

**Reinforcement:**

3.7mm (0.09") thick aluminum extrusion for hardware mounting. Full width integral horizontal, reinforcing truss at each pair of meeting rails. (minimum depth of 44.5mm (1 3/4"))

**Glazing:**

Self-aligning glazing retainer. 3mm (1/8") 6mm (1/4") thickglass or acrylic glazingOR 12.7mm (1/2") thick thermal glazing of two panes of glass.

**Weatherstripping:**

Neoprene bulb weatherstrip for bottom of door continuously supported. Dual between sections seals.

**Finish:**

A175A Clear anodizing to AA Spec A-21. A175W and A175T White Duracron Super 600 thermo-setting acrylic enamel.

**Hardware:**

Refer to hardware page. [Click HERE to view clearance charts and hardware specifications.](#)

**Design:**

Door design to meet industry-standard windload.

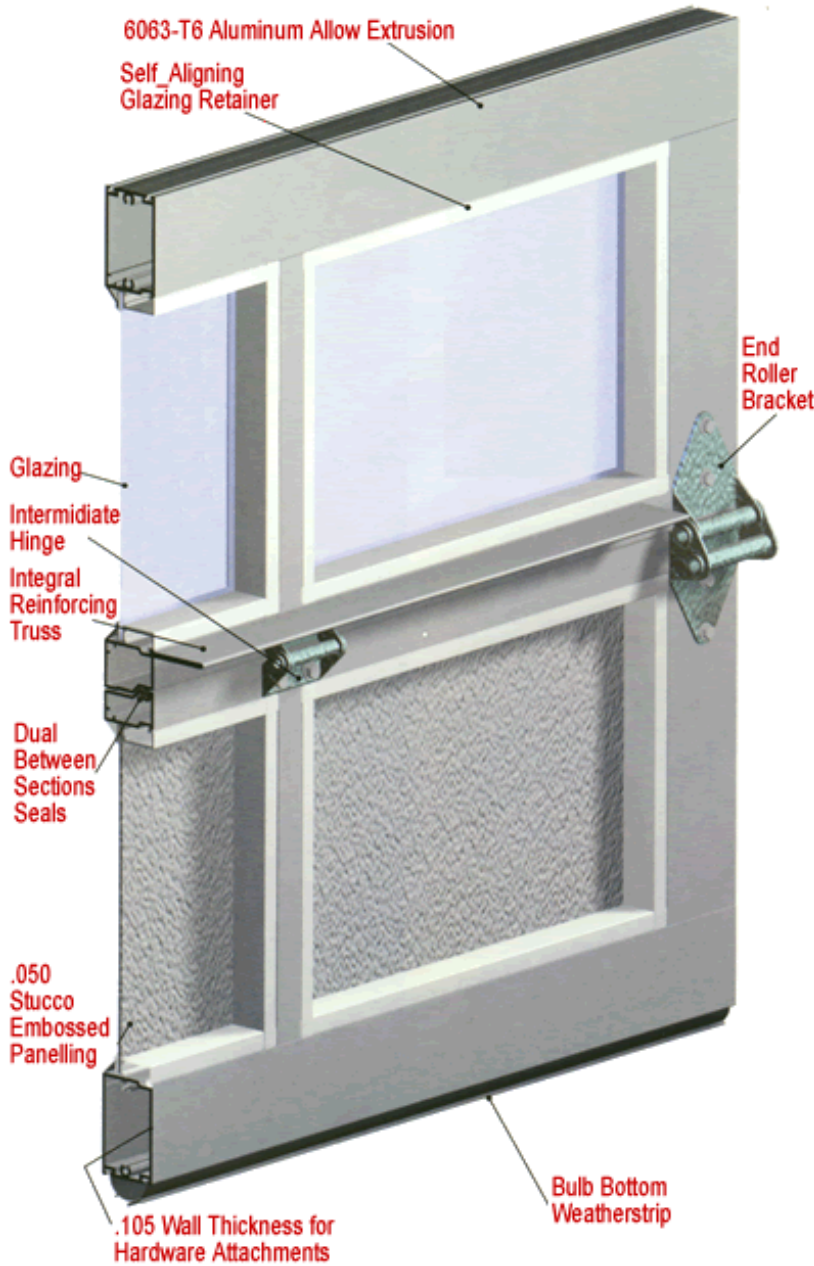

**Options for Alumatite Doors**

Exhaust port 75 [100]mm (3" [4" ]).

Model A175A

Custom anodized finishes available.

Model A175W

Custom colour, baked-on enamel and fluoropolymer finishes are available

Model A175A and A175W

Double-sided, reinforced kick panels in bottom section.

Door Opening Width	Panels Wide	Door Height	Sections High
Up to 9'2"	2	7'1" to 8'1"	4
9'3" to 12'2"	3	8'2" to 10'1"	5
12'3" to 16'2"	4	10'2" to 12'1"	6
		12'2" to 14'1"	8
		14'2" to 16'1"	9
		16'2" to 18'1"	